



A 8 Burchell Way, Kewdale WA 6105
T 08 9361 1355
E play@natureplaysolutions.com.au

STIRK PARK PLAY SPACE

CITY OF KALAMUNDA





8 Burchell Way
 Kewdale WA 6105
 (08) 9361 1355
 play@natureplaysolutions.com.au

STIRK PARK

ELIZABETH STREET, KALAMUNDA, WA, 6076

MASTERPLAN

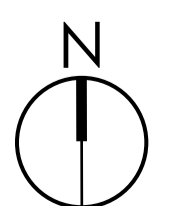

Job No: 4561
 Rev: F
 Date: May 2022
 Design: AL

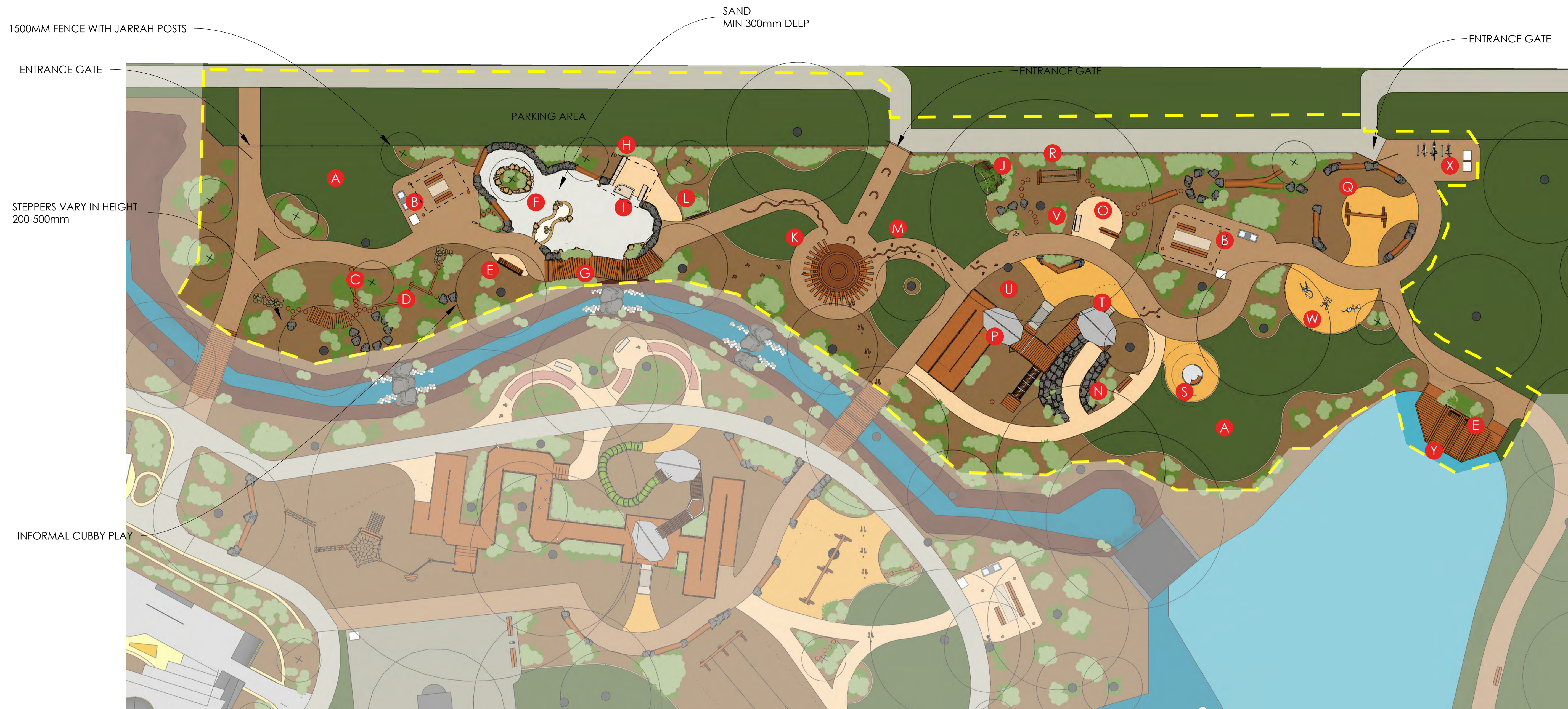

LEGEND

- | | | | | |
|--|--|--|-------------------|-------------------------|
| A OPEN TURF AREA | I BENCH SEAT WITH SAND PLAY TABLE* | Q A FRAME DOUBLE SWING WITH TODDLER SEAT* | LAWN | ROCK BOULDERS |
| B PICNIC TABLE WITH CHUNKY BENCH , BBQ, BIN & SHELTER & WATER FOUNTAIN* | J MIA MIA* | R ROPE WALK | QUARTZ SAND | CONCRETE STEPPER |
| C BALANCE SLEEPER | K TIMBER ABOUT MEETING PLACE* | S ACCESSIBLE CAROUSEL * | EXPOSED AGGREGATE | TIMBER STEPPER |
| D BALANCING LOG | L THONGAPHON* | T CONCRETE SLIDE 1200 * | COLOURED CONCRETE | LOG |
| E ACCESSIBLE BENCH SEAT WITH 3 ARMRESTS | M ANIMAL/HUMAN TRACKS | U CONCRETE SLIDE 1800 * | MULCH | CONCRETE KERB |
| F WATER CREEK WITH WATER FOUNTAIN* | N CHUNKY BENCH | V BENCH SEAT * | COLOURED CONCRETE | EXISTING TREE |
| G BOARDWALK* | O SHOP FRONT* | W OUTDOOR FITNESS EQUIPMENT | EXISTING PATH | PROPOSED TREE |
| H TRANSITION BENCH * | P ZIG ZAG CLIMBER - MINI WITH RAMP* | X BIKE STORE | EXISTING ROAD | PLANTS |
| | | Y VIEWING PLATFORM | IAS RUBBER | SHELTER/ROOF |
| | | | | FENCE WITH TIMBER POSTS |

*ACCESSIBLE

Scale Approx 1:200 @A1
0 5 10 20m



8 Burchell Way
Kewdale WA 6105
(08) 9361 1355
play@natureplaysolutions.com.au

STIRK PARK

ELIZABETH STREET, KALAMUNDA, WA, 6076

CONCEPT PLAN - AREA 1

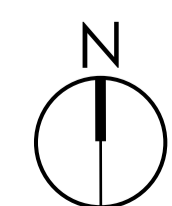

Job No: 4561
Rev: F
Date: May 2022
Design: AL



Q A FRAME DOUBLE SWING WITH TODDLER SEAT



W OUTDOOR FITNESS EQUIPMENT



G SHOP FRONT (FROM BACK)



O SHOP FRONT (FROM FRONT)



ENTRANCE GATE



K TIMBER ARBOR MEETING PLACE



G BOARDWALK



H I TRANSITION BENCH, BENCH SEAT & SAND PLAY TABLE



F WATER CREEK WITH WATER FOUNTAIN



B PICNIC TABLE WITH CHUNKY BENCH, BBQ, BIN,



C D JOURNEY PATHWAY WITH BALANCE SLEEPER AND LOG



A OPEN TURF AREA



8 Burchell Way
Kewdale WA 6105
(08) 9361 1355
play@natureplaysolutions.com.au

STIRK PARK

ELIZABETH STREET, KALAMUNDA, WA, 6076

AREA 1 - PERSPECTIVES



Job No: 4561
Rev: F
Date: May 2022
Design: AL

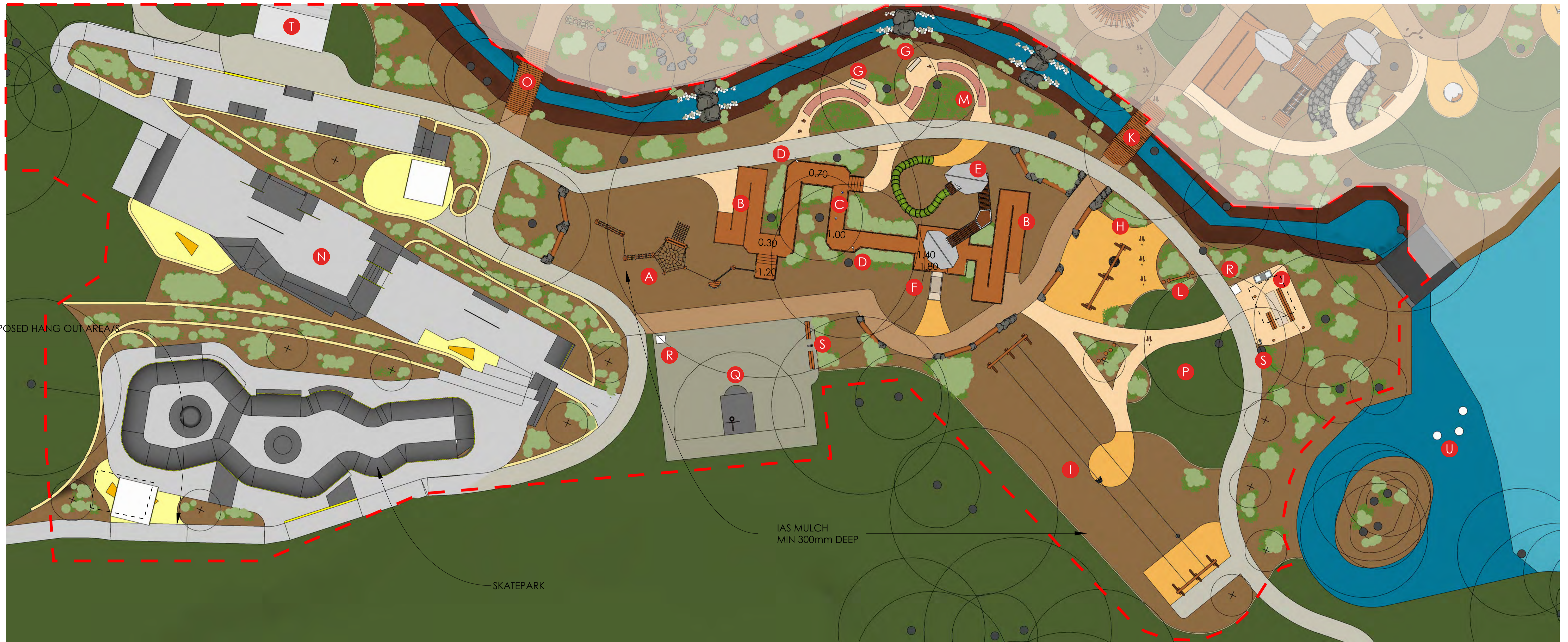

LEGEND

- | | | | | |
|--------------------------------|--|--------------------------------|-------------------|------------------|
| A POSSUM HANGOUT | I FLYING FOX DOUBLE * | Q BASKETBALL AREA - 3X3 | LAWN | ROCK BOULDERS |
| B ZIG ZAG BOARDWALK* | J PICNIC TABLE WITH CHUNKY BENCH & SHELTER* | R BINS | QUARTZ SAND | CONCRETE STEPPER |
| C THREAD CHIMES* | K HISTORIC BRIDGE WITH ARBOUR* | S DRINKING FOUNTAIN | EXPOSED AGGREGATE | TIMBER STEPPER |
| D TALKING TUBES * | L BALANCE SLEEPER 1.8M | T TOILET BLOCK | MULCH | LOG |
| E ZIG ZAG CLIMBER | M SCHOOL TILED PATHWAY* | U WATER MISTERS | COLOURED CONCRETE | CONCRETE KERB |
| F CONCRETE SLIDE 1800 * | N SKATE PARK | | EXISTING PATH | EXISTING TREE |
| G BENCH SEAT CONCRETE * | O BRIDGE* | | EXISTING ROAD | PROPOSED TREE |
| H TRIPLE SWING * | P OPEN TURF AREA | | IAS RUBBER | PLANTS |

*ACCESSIBLE

Scale Approx 1:200 @A1
0 5 10 20m

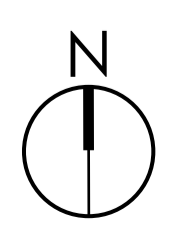



A POSSUM HANGOUT



B ZIG ZAG BOARDWALK



B E ZIG ZAG BOARDWALK WITH CLIMBER



B E F ZIG ZAG BOARDWALK WITH CLIMBER & CONCRETE SLIDE



F CONCRETE SLIDE



G M SCHOOL TILED PATHWAY WITH CONCRETE BENCH



G M SCHOOL TILED PATHWAY WITH CONCRETE BENCH



H TRIPLE SWING



J R S PICNIC TABLE WITH CHUNKY BENCH, DRINKING FOUNTAIN AND BIN WITH SHELTER



J R S PICNIC TABLE WITH CHUNKY BENCH, DRINKING FOUNTAIN AND BIN WITH SHELTER



I FLYING FOX DOUBLE



I FLYING FOX DOUBLE



8 Burchell Way
Kewdale WA 6105
(08) 9361 1355
play@natureplaysolutions.com.au

STIRK PARK

ELIZABETH STREET, KALAMUNDA, WA, 6076

AREA 2 - PERSPECTIVES

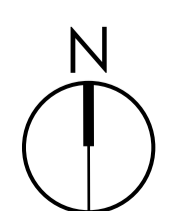

Job No: 4561
Rev: F
Date: May 2022
Design: AL